



INSTRUCTIONS

-J01291

REV. 10-29-01

Kit Numbers 62454-02 (Silver), 62453-02 (Black)

CAM-CAVITY VENT-TUBE KIT

General

This kit fits 1993 – 2001 FLT model motorcycles.

CAUTION

To avoid burns to hands and fingers, allow the engine and exhaust pipes to cool before installing this kit.

NOTE

A Service Manual for your model motorcycle is available from your Harley-Davidson Dealer.

Installation

NOTE

1993 – 1999 1340 V2 engines do not use the vent tube. For oil-fill spout installations only, replace the stock fill spout per steps 8 – 10 below. Install the plug (5) into the threaded hole on the right side of the oil-fill spout (6) and torque the plug to 10 – 14 ft-lbs.

1. See Figure 1. Remove the hose clamp fastening the crankcase vent tube to the straight fitting on the cam cavity.
2. Remove the hose clamp fastening the crankcase vent tube to the elbow fitting on the crankcase.
3. Remove the nipple from the elbow fitting to provide clearance for unscrewing the elbow fitting.
4. Unscrew the elbow fitting from the crankcase.
5. See Figure 2. Replace the elbow fitting, removed in step 3 from the crankcase, with the pipe plug. Screw the plug in until snug.
6. See Figure 1. Remove the stock straight fitting from the cam cavity.
7. See Figure 2. Replace the stock straight fitting, removed in step 6 from the cam cavity, with the new fitting. Torque the fitting to 10 – 14 ft-lbs (13 – 19 Nm).
8. See Figure 1. Remove the stock oil-fill spout from the transmission housing. Discard the stock screws. Save the dipstick for installation.
9. Carefully clean stock gasket material from the transmission housing at the spout location, taking care to prevent scratching the housing and prevent material from entering the oil cavity in the housing.
10. Fasten the new oil-fill spout (6) and gasket (1) to the transmission housing using four new screws. Torque the screws to 7 – 9 ft-lbs (10 – 12 Nm).

11. See Figure 2. Screw the straight fitting into the threaded hole on the right side of the oil-fill spout (6). Torque the fitting to 10 – 14 ft-lbs.
12. Place two new hose clamps (3) loosely on the new vent tube (4).

NOTE

The new vent tube is formed to fit in one direction only. Fasten the new vent tube end with the MOTOR inscription and directional arrow, printed on the tube, attached to the straight fitting on the cam cavity.

11. See Figure 2. Fasten the new vent tube (4) between the straight fittings (2) on the oil-fill spout (6) and the cam cavity. Secure the tube to the fittings using the new hose clamps (3).
12. Fasten the dipstick snugly into the oil-fill spout.

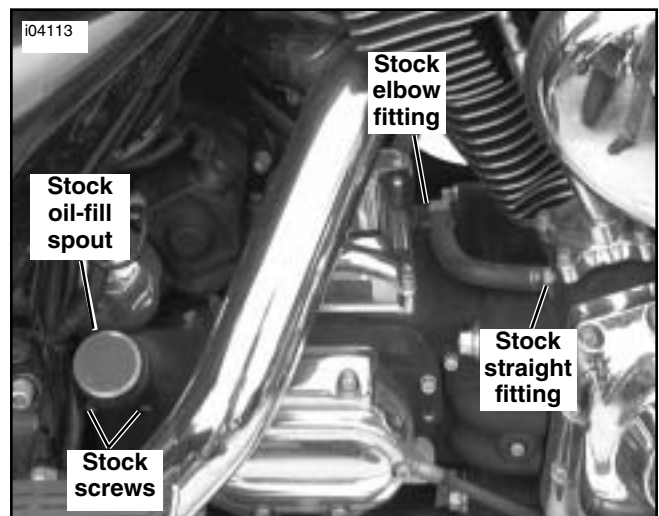

Figure 1. Stock Material Removal

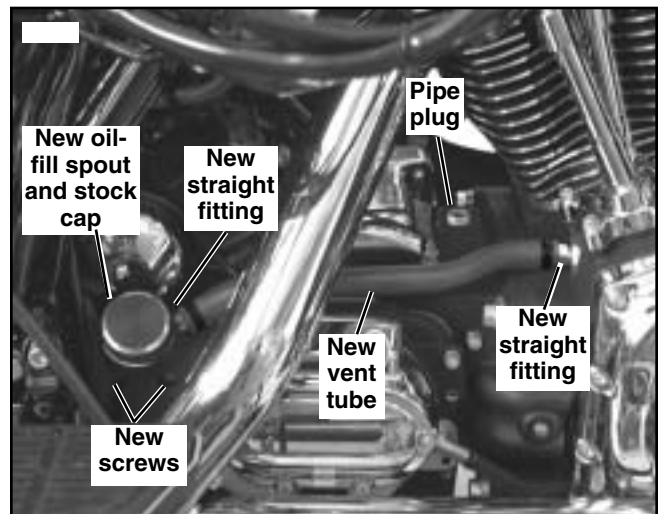

Figure 2. New Material Installed



Service Parts

Part No. 62454-02, 62453-02

Date 10/01

Crankcase Vent Tube Kit

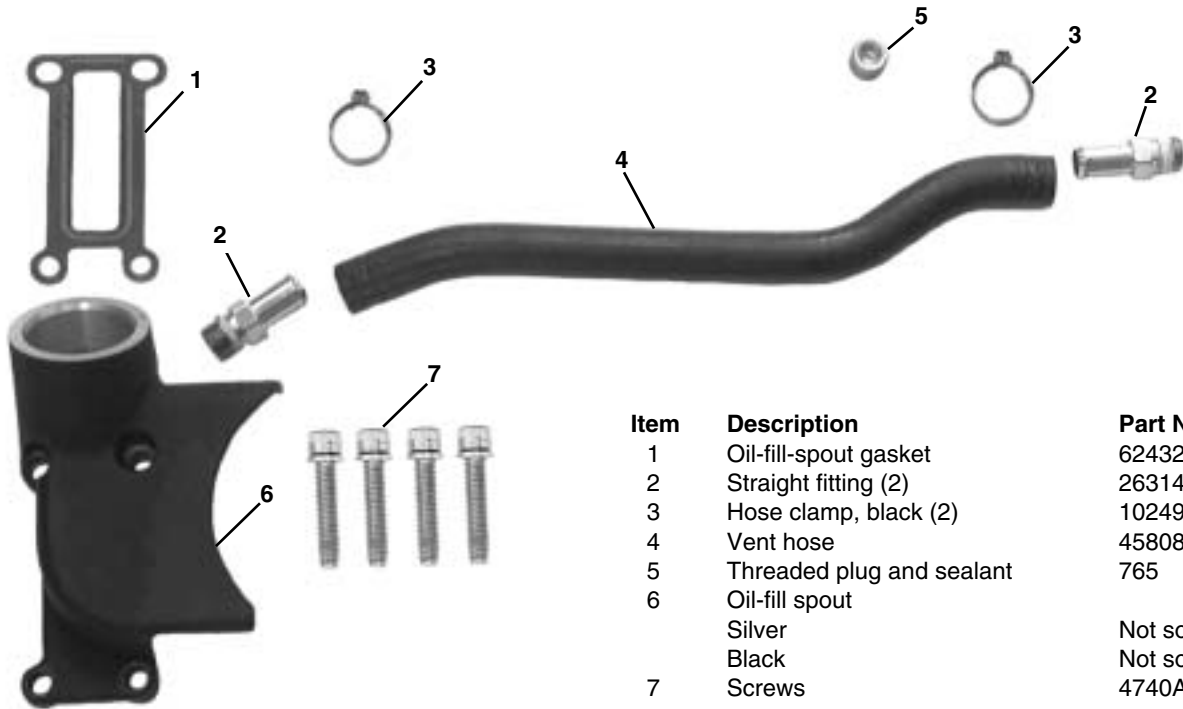

| Item | Description | Part No. |
|------|---------------------------|-----------|
| 1 | Oil-fill-spout gasket | 62432-93A |
| 2 | Straight fitting (2) | 26314-99 |
| 3 | Hose clamp, black (2) | 10249 |
| 4 | Vent hose | 45808-02 |
| 5 | Threaded plug and sealant | 765 |
| 6 | Oil-fill spout | |
| | Silver | Not sold |
| | Black | Not sold |
| 7 | Screws | 4740A |