

ADJUSTMENT

NOTE

Perform the clutch adjustment with the motorcycle at room temperature. The clearance at the adjuster screw will increase as the powertrain temperature increases. If adjuster screw is adjusted with power train hot, clearance at push rod bearing could be insufficient with power train cold and clutch slippage could occur.

1. Position motorcycle on a suitable lift, upright and level. Point front wheel straight ahead.
2. Remove five TORX screws with captive washers to detach clutch inspection cover from primary chaincase cover.
3. Remove and discard seal.
4. See [Figure 1-20](#). Add free play to cable.
 - a. Slide rubber boot (1) off cable adjuster.
 - b. Holding cable adjuster (2) with 1/2 in. wrench, loosen jam nut (3) using a 9/16 in. wrench.
 - c. Turn cable adjuster (2) until there is a large amount of free play at clutch hand lever.
5. See [Figure 1-21](#). Loosen jam nut (1) on clutch adjuster screw (2). To take up all free play, turn screw inward (clockwise) until lightly seated. Activate the clutch lever to verify the balls are seated in the ramps.
6. Back out adjusting screw (counterclockwise) 1/2 to 1 full turn. Tighten jamnut to 72-120 **in-lbs** (8.1-13.6 Nm), while holding adjusting screw with an Allen wrench.
7. Squeeze clutch lever to maximum limit three times, to set ball and ramp release mechanism.
8. Check free play.
 - a. Turn cable adjuster away from jam nut until slack is eliminated at hand lever.
 - b. See [Figure 1-22](#). Pull clutch cable ferrule (2) away from clutch lever bracket (3) to check free play. Turn cable adjuster as necessary to obtain 1/16-1/8 in. (1.6-3.2 mm) free play between end of cable ferrule and clutch lever bracket.
9. Hold adjuster with 1/2 in. wrench. Using 9/16 in. wrench, tighten jam nut against cable adjuster. Cover cable adjuster mechanism with rubber boot.

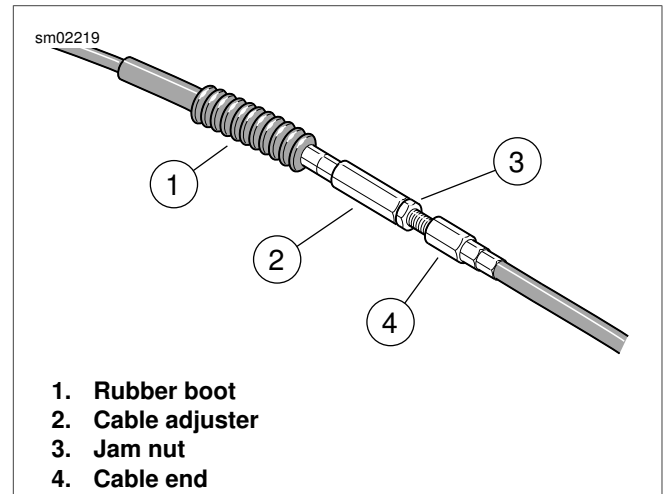

Figure 1-20. Clutch Cable Adjuster

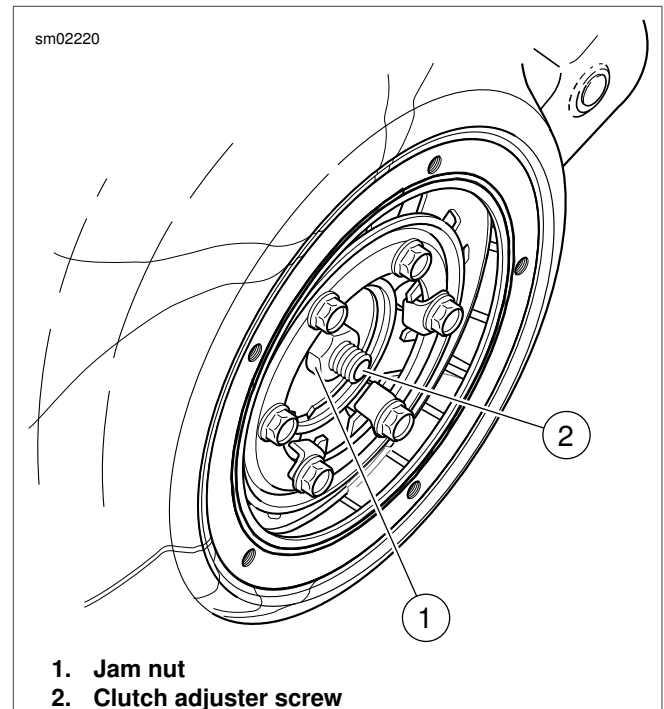

Figure 1-21. Clutch Adjuster Screw

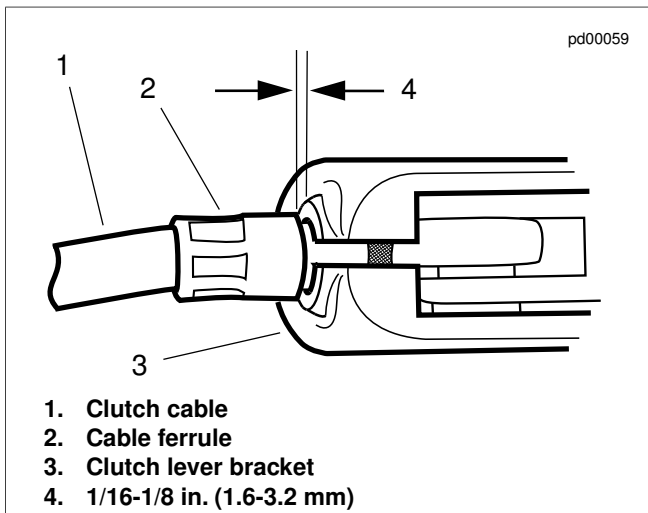

Figure 1-22. Clutch Hand Lever

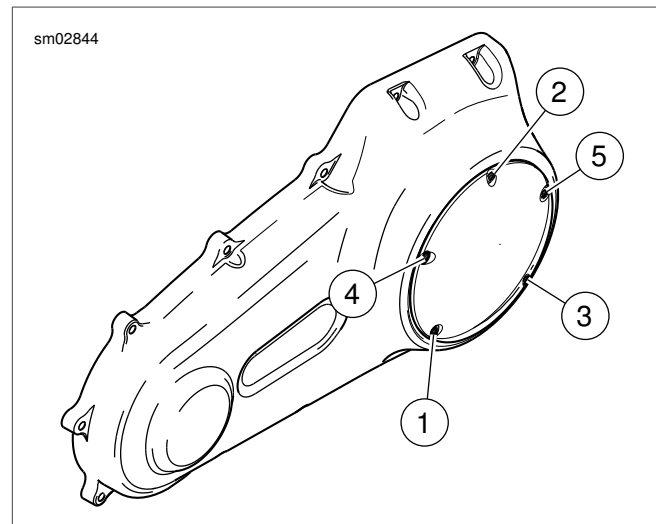

Figure 1-23. Clutch Cover Torque Sequence

10. Install clutch inspection cover and **new** seal as follows:
 - a. Thoroughly wipe all lubricant from cover mounting surface and groove in chaincase.
 - b. Position **new** seal (1) in groove in primary chaincase cover and press each of the nubs on seal into the groove. The nubs will retain seal in position.
 - c. Insert screw (with captive washer) through clutch inspection cover and carefully thread it into the top cover screw hole.
 - d. Start the remaining four screws (with captive washers).
 - e. Alternately tighten screws to 84-108 **in-lbs** (9.5-12.2 Nm) following torque sequence shown in [Figure 1-23](#).